

# GARRELL

ASSOCIATES INC.  
 790 PEACHTREE INDUSTRIAL BLVD., SUITE 200  
 SUWANEE, GA 30024  
 PH.(770)-614-3239 FAX(770)-614-5948  
 WWW.GARRELLASSOCIATES.COM

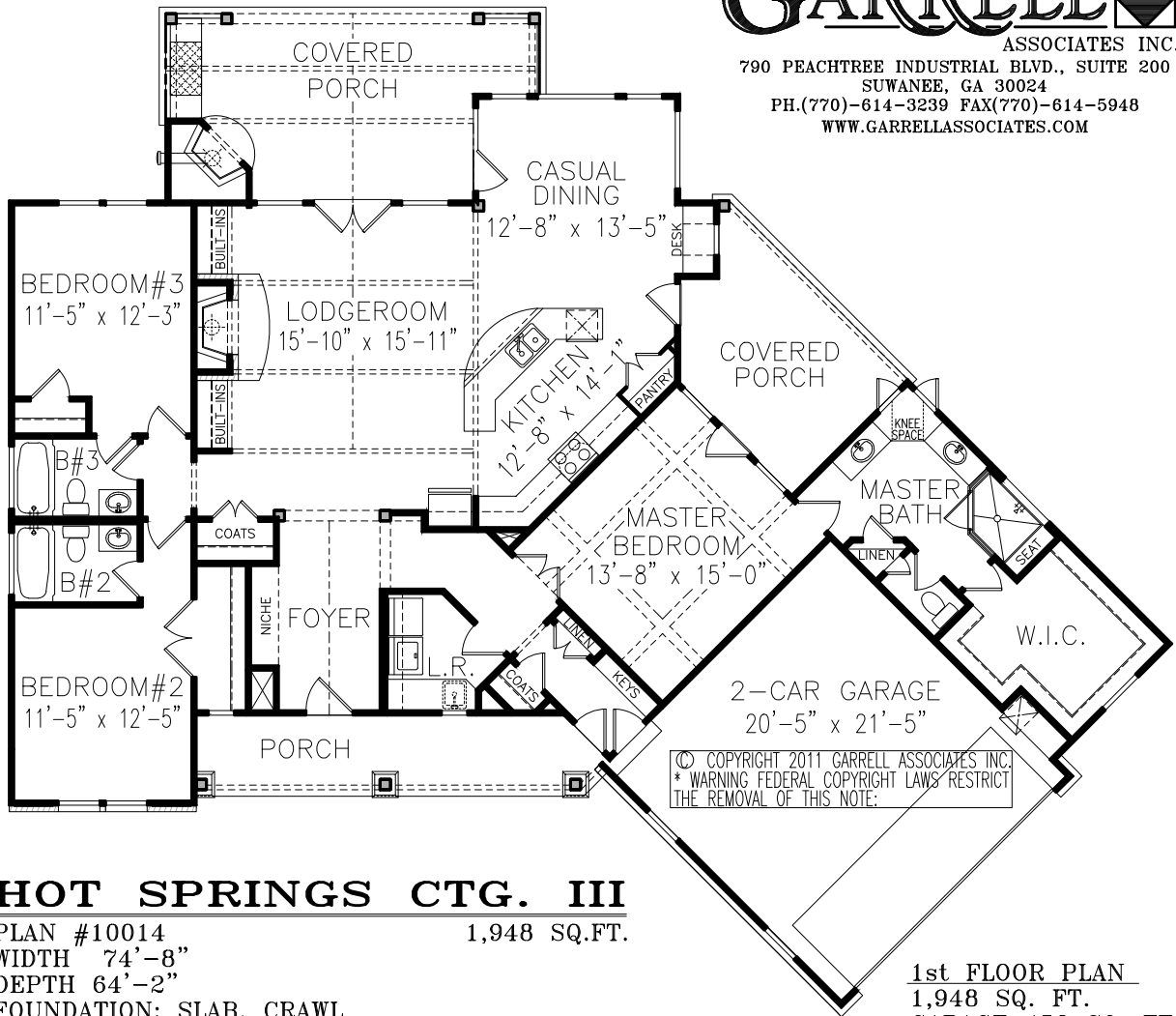

© COPYRIGHT 2011 GARRELL ASSOCIATES, INC.  
 \* WARNING FEDERAL COPYRIGHT LAWS RESTRICT  
 THE REMOVAL OF THIS NOTE.

## HOT SPRINGS CTG. III

PLAN #10014  
 WIDTH 74'-8"  
 DEPTH 64'-2"  
 FOUNDATION: SLAB, CRAWL

1,948 SQ.FT.

1st FLOOR PLAN  
 1,948 SQ. FT.  
 GARAGE 458 SQ. FT.

ARTIST'S CONCEPTION MAY VARY FROM ACTUAL PLAN